

1. Pieces & Parts

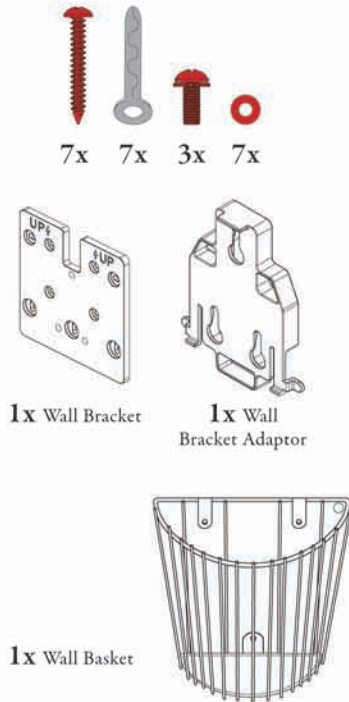

2. Attaching the Wall Bracket

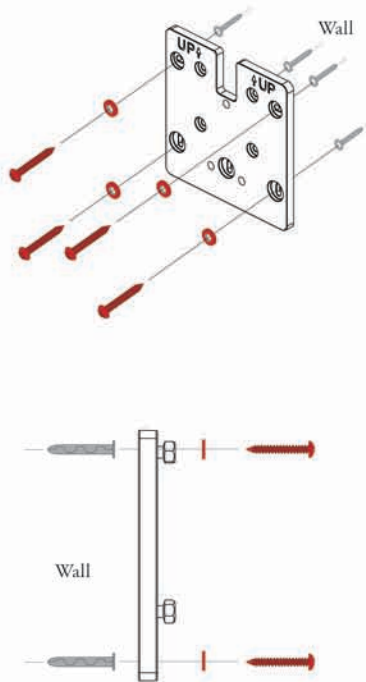

3. Attaching the Wall Bracket Adaptor

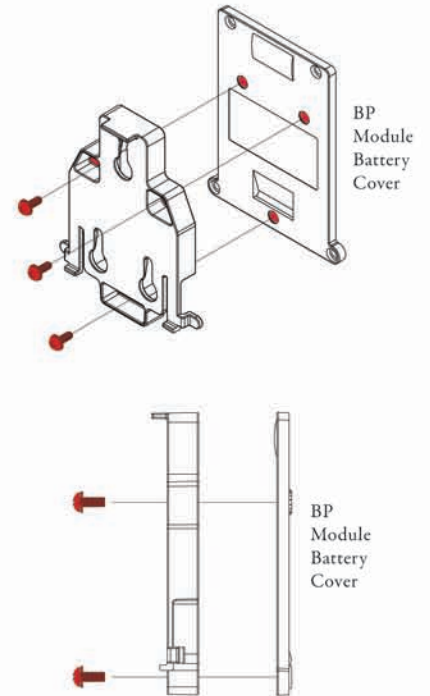

4a. Attaching the BP Module

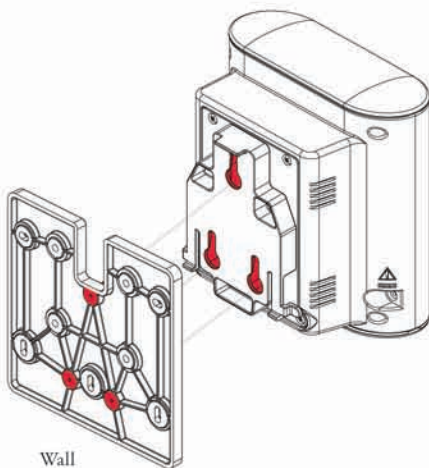

4b. Attaching the BP Module

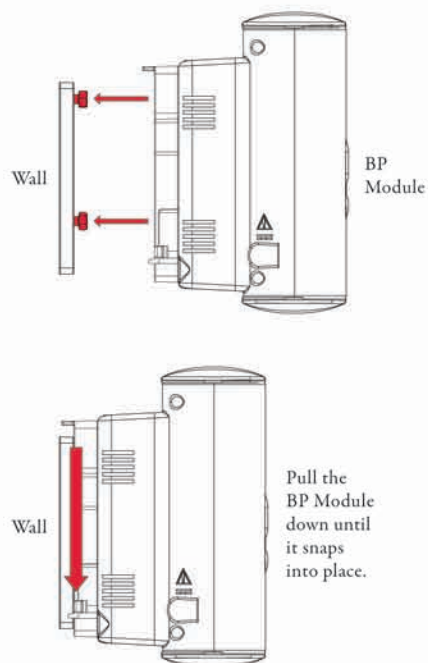

5. Attaching the Wall Basket

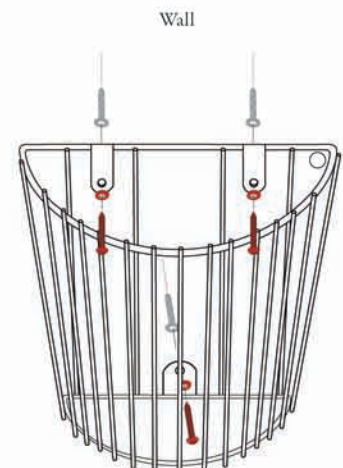

1.

Replacing a Welch Allyn Wall Aneroid

- a. Remove the screw at the bottom of the basket behind the wall aneroid.
- b. Remove the aneroid.
- c. Remove the top two screws connecting the basket to the wall.
- d. Slide the basket up and towards you to remove it from the wall.

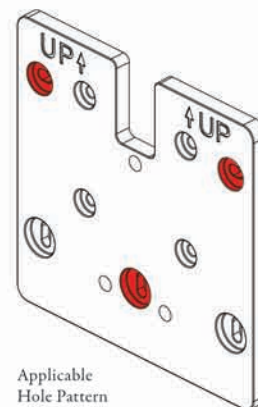

Applicable
Hole Pattern

2.

Replacing an ADC Wall Aneroid

- a. Remove the screws at the top and the bottom of the wall aneroid.
- b. Remove the aneroid.
- c. Remove the screws attaching the bracket to the wall.

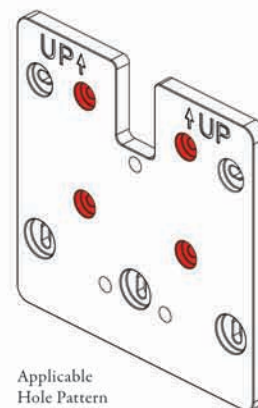

Applicable
Hole Pattern

3.

Replacing a Medline Wall Aneroid

- a. Remove the screws at the top and the bottom of the wall aneroid.
- b. Remove the aneroid.
- c. Remove the screws attaching the bracket to the wall.

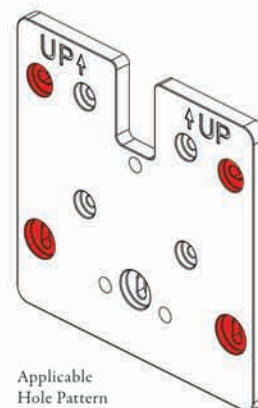

Applicable
Hole Pattern



ADC
55 Commerce Drive
Hauppauge, NY 11788



Suntech Medical, Ltd.
Oakfield Industrial Estate
Eynsham, Oxfordshire
OX29 4TS UK

Inspected in the U.S.A.
Made in China
tel: 631-273-9600
toll free: 1-800-232-2670
fax: 631-273-9659

www.adctoday.com/adview
info@adctoday.com

To Register Your Product, visit us at
www.adctoday.com
and follow the links

For questions, comments, or suggestions,
call in the U.S.A. Toll Free:
1-800-ADC-2670