



e-sphyg3™

Quick Start Guide



1 Charge the Battery

Charge the battery before using for the first time. Select the appropriate power plug and connect to the power adapter as shown. Plug into power adapter socket at back of unit and plug into wall outlet. Charge battery until recharge indicator on main unit turns **green**.

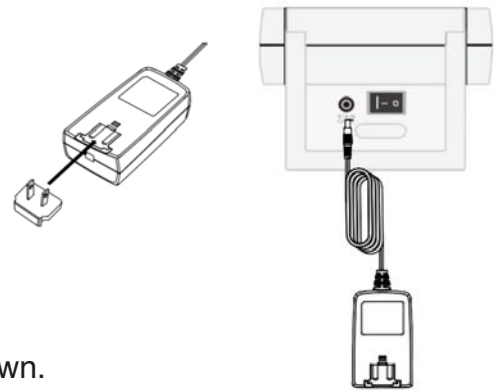

2 Select and Connect the Cuff

Connect one end of the extension BP hose to the E3 as shown.

Connect the appropriate cuff to the hose metal connector, by pushing the male bayonet on the cuff hose into the receiver on the extension hose.

When properly seated the male bayonet will snap into place.

To release, slide the outer sleeve of the receiver back.

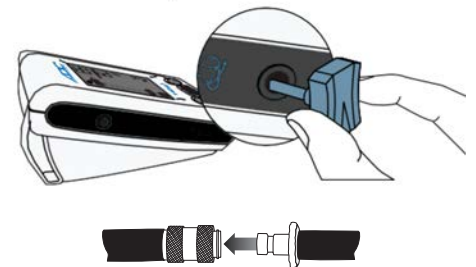

3 Turn the Unit On

Press On/Off switch at back of unit to power on.

The unit will beep twice, the display will illuminate, and the unit will perform a self check. If an error message appears, do not use and contact ADC.

The unit will display a "0" when ready for measurement.

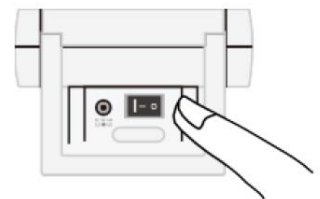

4 Apply the Cuff

Apply the cuff to the patient's upper arm. Align the artery mark with the patient's brachial artery.

Ensure the cuff is correctly sized for the patient – the index line should fall between the range lines. If it does not, select a larger or smaller cuff as indicated.

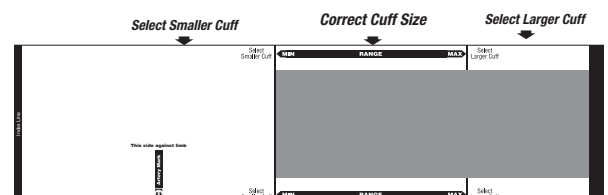
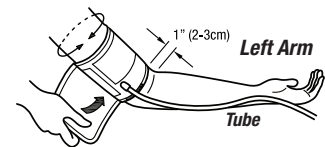

5 Set Maximum Inflation Pressure in Single Measurement* Mode

By default, inflation pressure is set to auto.

If you wish to change the pressure:

- 1) Press and hold the Memory Button for three seconds until the column with pressure values flashes.
- 2) Press the Start/Stop Button to cycle through the pressure values until you've highlighted the one you want.
- 3) Press the Memory Button to confirm and set the new value.

Once max pressure is set, press the Start/Stop Button to begin a single measurement.

Unit will display and store reading when measurement is completed.

*Consult the complete Instructions for Use for information on changing to and using manual mode or the programmable average mode. Visit www.adctoday.com/esphyg3.



6 For Best Results

- Allow the patient to sit quietly for two to five minutes before measurement.
- Use the proper size cuff; if two cuff sizes fit, use the larger one.
- Place the cuff on a bare arm.
- Position the artery mark over the brachial artery.
- Apply the cuff snugly, allowing room for no more than two fingers between the cuff and patient's arm.
- Support the patient's back and feet; keep legs uncrossed.
- Keep the upper arm at heart level with the lower arm passively supported (e.g., resting on lap).
- Keep the arm still during the measurement cycle.
- Do not talk to the patient while taking a blood pressure reading.

Download full manual at www.adctoday.com/esphyg3



American Diagnostic Corporation
55 Commerce Drive
Hauppauge, NY 11788 USA
1-800-ADC-2670
www.adctoday.com