

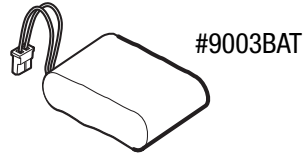

High-Capacity Battery Installation



1

Press On/Off switch at back of unit to power off the unit.

Unplug power adapter socket from the back of the unit.

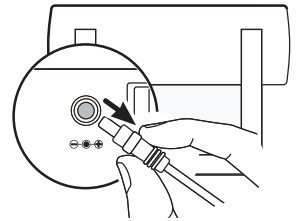
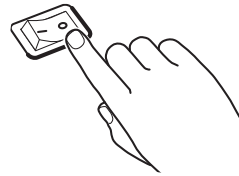
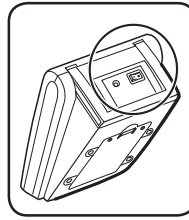

2

Remove both screws with a Philips screw driver.

Slide out back cover.

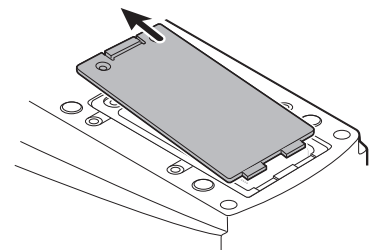
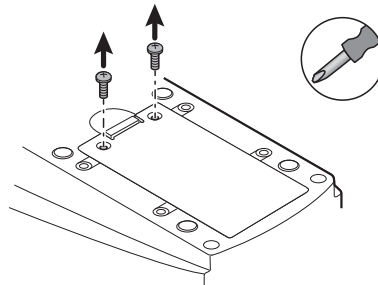
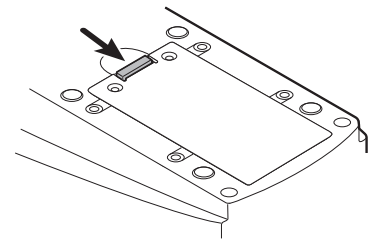
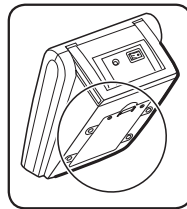

3

Remove the existing battery power pack.

Please do not dispose of battery in municipal waste.

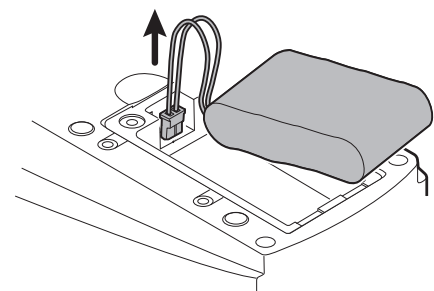

4 Insert new battery power pack. Make sure exposed battery wires are tucked underneath the battery power pack so that the battery cover can slide back on.

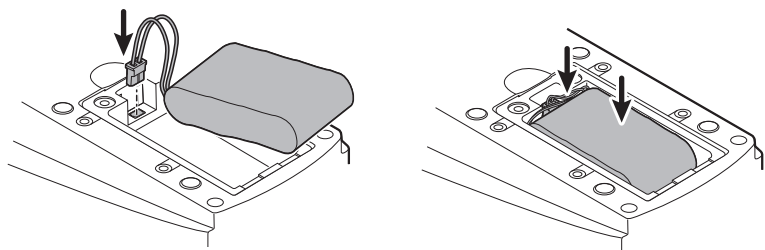

5 Slide in the battery cover back into position and replace screws.

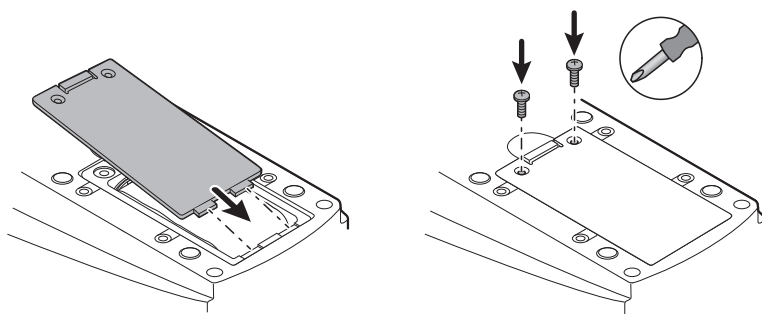

6 Plug in power adapter socket at back of device and plug into wall outlet. Charge battery until re-charge indicator on main unit turns **green**.

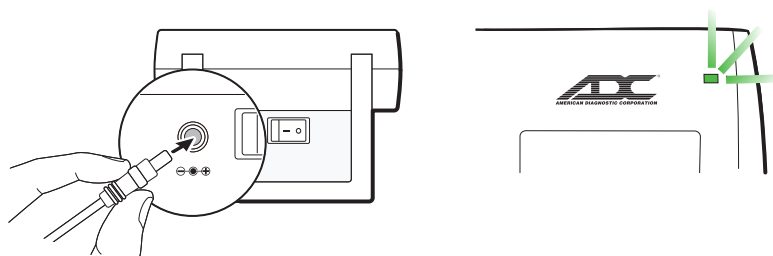

Download full manual at www.adctoday.com/esphyg3



American Diagnostic Corporation
55 Commerce Drive
Hauppauge, NY 11788 USA
1-800-ADC-2670
www.adctoday.com

IFU p/n: 93-9003BAT-00 rev 0 (09/23/2021)